

COUNTY OF SAN JOAQUIN

DEPARTMENT OF PUBLIC WORKS
P.O. BOX 1810-1810 E. HAZELTON AVENUE
STOCKTON, CALIFORNIA 95201
(209) 468-3000
FAX # (209) 468-9324

Permit No: PS-1600996
Date Issued: 04/14/2016
Start Date: 04/29/2016
Exp. Date: 10/24/2016
Project No: PWP110005
Quad: ES

ENCROACHMENT PERMIT

To: CALTRANS
611 SAN JUAN AVE.
STOCKTON, CA 95203

Encroachment Type:

Detour & Traffic Control	Devices		
--------------------------	---------	--	--

Location:

GOLDEN GATE AVE OFF HWY 99 - CROSSTOWN FREEWAY VIADUCT CLOSURE FOR REPAIRS

In compliance with your request of 04/14/2016, permission is hereby granted to do work in County right-of-way as shown on attached application and subject to all the terms, conditions and restrictions written below or printed as general or special provisions on any part of this form. See reverse side and attached sheet, if any.

Trench excavations for service connections will not be permitted within ten feet (10') of pavement centerline unless otherwise approved by the Director. Surface of trench patches shall match in kind and be smooth and even with that of abutting surface. Special attention shall be given to depth of utilities through roadside area in anticipation of future drainage facilities, road profile and/or frontage development. All underground utility facilities are to be established and accurately dimensioned on sketches from surveyed centerline of road right of way, or from right of way (border) lines.

Permittee shall call the Department of Public Works, Field Engineering Division (Permit Inspections) at (209)953-7421 at least forty-eight hours prior to beginning any work within the County right of way. All work performed under this permit shall conform to the rules and regulations pertaining to safety established by the California Division of Industrial Safety and Cal-OSHA.

The jobsite shall be kept in a safe condition at all times by the daily removal of any excess dirt or debris which might be a hazard to either pedestrian or automobile traffic. All necessary traffic convenience and warning devices and personnel shall be provided, placed and maintained by and at the sole expense of the Permittee in accordance with the latest edition of the CALTRANS Manual of Traffic Control.

After completion of the work permitted herein, all debris, lumber, barricades, or any excess material shall be removed and the jobsite left in a neat workmanlike manner. Immediately following completion of construction permitted herein, Permittee shall fill out and mail notice of completion (see attached post card) provided by Grantor.

Special Comments:

Traffic Control Per MUTCD***** (8) - 55-Hour Closures (Starts 10:00 PM Friday Night - Ends 5:00 AM Monday Morning)***** Closure Dates: 4/29/2016; 5/20/2016; 6/3/2016; 6/10/2016; 8/5/2016; 8/19/2016; 10/14/2016; 10/21/2016*****

*****This permit is for detours and traffic control devices only*****

FORMS:

--	--	--

Est. Permit Fee: \$0.00

WHITE -Permittee
GOLDENROD -PWD Central File
YELLOW -Field Inspection
PINK -Permit Section

KRIS BALAJI, Director
Department of Public Works

By:

Permit Section

ENCROACHMENT PERMIT GENERAL PROVISIONS

13-1

1. This permit is issued under and subject to all laws and ordinances of agencies governing the encroachment herein permitted. See the following references:
STREETS AND HIGHWAYS CODE
 1. Division 1, Chapter 3
 2. Division 2, Chapter 2, Section 942
 3. Division 2, Chapter 4, Section 1126
 4. Division 2, Chapter 5.5 and Chapter 6
SAN JOAQUIN COUNTY ORDINANCES NUMBERED: 324, 441, 648, 662, 672, 695, 700, 860, 892, 3359, and 3675.
2. It is understood and agreed by the Permittee that the performance of any work under this permit shall constitute an acceptance of all the provisions contained herein and failure on the Permittee's part to comply with any provision will be cause for revocation of this permit. Except as otherwise provided for public agencies and franchise holders, this permit is revocable on five days notice.
3. All work shall be done subject to the supervision of and the satisfaction of the grantor. The Permittee shall at all times during the progress of the work keep the County Highway in as neat and clean condition as is possible and upon completion of the work authorized herein, shall leave the County Highway in a thoroughly neat, clean and usable condition.
4. The Permittee also agrees by the acceptance of this permit to properly maintain any encroachment structure placed by the Permittee on any part of the County Highway and to immediately repair any damage to any portion of the highway, which occurs as a result of the maintenance of the said encroachment structure, until such time as the Permittee may be relieved of the responsibility for such maintenance by the County of San Joaquin.
5. The Permittee also agrees by the acceptance of this permit to make, at its own expense, such repairs as may be deemed necessary by the County Department of Public Works.
6. It is further agreed by the Permittee that whenever construction, reconstruction or maintenance work upon the highway is necessary, the installation provided for herein shall, upon request of the County Department of Public Works, be immediately moved or removed by and at the sole expense of the Permittee.
7. No material used for fill or backfill in the construction of the encroachment shall be borrowed or taken from within the County right of way.
8. All work shall be planned and carried out with as little inconvenience as possible to the traveling public. No material shall be stacked within eight feet (8') of the edge of the pavement or traveled way unless otherwise provided herein. Adequate provision shall be made for the protection of the traveling public. Traffic control standards shall be utilized including barricades; approved signs and lights; and flagmen, as required by the particular work in progress.
9. The Permittee, by the acceptance of this permit, shall assume full responsibility for all liability for personal injury or damage to property which may arise out of the work herein permitted or which may arise out of the failure of the part of the Permittee to properly perform the work provided under this permit. In the event any claim of such liability is made against the County of San Joaquin or any department, official or employee thereof, the Permittee shall defend, indemnify, and hold each of them harmless for such claim.
10. All backfill material is to be moistened as necessary and thoroughly compacted with mechanical means. If required by the County Director of Public Works, such backfill shall consist of gravel or crushed rock. The Permittee shall maintain the surface over structures placed hereunder as may be necessary to insure the return of the roadway to a completely stable condition and until relieved of such responsibility by the County Department of Public Works. Wherever a gravel, crushed rock or asphalt surface is removed or damaged in the course of work related to the permitted encroachment, such material shall either be separately stored and replaced in the roadway as nearly as possible in its original state or shall be replaced in kind, and the roadway shall be left in at least as good a condition as it was before the commencement of operations of placing the encroachment structure.
11. Whenever it becomes necessary to secure permission from abutting property owners for the proposed work, such authority must be secured by the Permittee prior to starting work.
12. The current and future safety and convenience of the traveling public shall be given every consideration in the location and methods of construction utilized.
13. The Permittee is responsible for the preservation of survey monuments located within the area of work herein permitted. Prior to the start of construction, survey monuments that potentially may be disturbed shall be located and referenced by a Licensed Land Surveyor, and a Corner Record filed with the County Surveyor. Any Survey Monuments disturbed during the course of construction shall be reestablished by a Licensed Land Surveyor and another Corner Record filed with the County Surveyor. (Land Surveyors' Act Section 8771)
14. Prior to any excavation, the Permittee shall notify USA North (Underground Service Alert of Northern California and Nevada) at 811 or 800-227-2600 forty-eight (48) hours in advance.

APPLICATION FOR ENCROACHMENT PERMIT

PLEASE PRINT:

Date 04/13/16

To: San Joaquin County
Department of Public Works

CALTRANS

(Applicant Name)

611 SAN JUAN AVENUE

(Mailing Address)

STOCKTON, CA, 95203

(City, State, Zip Code)

209-639-4686

(Area Code - Telephone Number)

OFFICE USE ONLY

JOB # 110005 REF # _____
APN _____ CR # _____
EXP. DATE SEE DATES BELOW
VALID _____ TO _____ DRIVEWAYS: _____
STREET GOLDEN GATE AVE * _____
AREA STOCKTON QUAD ES * _____
TYPE DETOUR & TRAFFIC CONTROL DEVICES
FORMS /
NOTES _____

Sketch (Detailed plans may be submitted)

SEE ATTACHED TRAFFIC HANDLING PLANS.

(8) - 55 HOUR CLOSURES (STARTS 10:00 PM FRIDAY - ENDS 5:00 A.M. MONDAY)

DATES OF CROSSTOWN CLOSURES:

4/29/16 - 5/2/16 8/5/16 - 8/8/16
5/20/16 - 5/23/16 8/19/16 - 8/22/16
6/3/16 - 6/6/16 10/14/16 - 10/17/16
6/10/16 - 6/13/16 10/21/16 - 10/24/16

The undersigned hereby applies for permission to excavate, construct and/or otherwise encroach on County Highway Right-of-Way on _____ GOLDEN GATE AVENUE _____ approximately 0.40 _____ /mile WEST of HIGHWAY 99 _____, by performing the following work (description of work): Golden Gate Ave. will be used as one of the detour routes during the 55-hour full closures of the Crosstown Freeway (SR-4). There will be eight 55-HR closures (4-WB & 4-EB), all of which starts @ 10 pm Friday & ends @ 5 am Monday. The scheduled dates of weekend closures are as follows: WB - 04/29/16, 05/20/16, 08/19/16, 10/14/16, EB - 06/03/16, 06/10/16, 08/05/16, 10/21/16. The 55-HR closures allows for the reconstruction of structure hinges, replacement of joint seals, and elastomeric bearing pads at the Crosstown Freeway Viaduct.

Work will commence on or about _____ see description above _____ for approximately _____ days.

I, the undersigned, certify that I am the owner of the respective property, or am qualified to represent the owner and agree to do the work described above in accordance with the rules and regulations of San Joaquin County and subject to inspection and approval.

Ariel Mendoza - Resident Engineer

Signature of Applicant - Title

04/13/16

Date



55-HR CLOSURE



BLACKOUT DATES



MOBILIZE



DEMOBILIZE

JANUARY						
SUN	MON	TUE	WED	THU	FRI	SAT
					1	2
3	4	5	6	7	8	9
10	11	12	13	14	15	16
17	18	19	20	21	22	23
24	25	26	27	28	29	30
31						

FEBRUARY						
SUN	MON	TUE	WED	THU	FRI	SAT
	1	2	3	4	5	6
7	8	9	10	11	12	13
14	15	16	17	18	19	20
21	22	23	24	25	26	27
28	29	1				

MARCH						
SUN	MON	TUE	WED	THU	FRI	SAT
			2	3	4	5
6	7	8	9	10	11	12
13	14	15	16	17	18	19
20	21	22	23	24	25	26
27	28	29	30	31		

APRIL						
SUN	MON	TUE	WED	THU	FRI	SAT
					1	2
3	4	5	6	7	8	9
10	11	12	13	14		
17	18	19	20	21	22	23
24	25	26	27	28	29	30

04/29-05/02
WB HINGE 29

MAY						
SUN	MON	TUE	WED	THU	FRI	SAT
1	2	3	4	5	6	7
8	9	10	11	12	13	
15	16	17	18	19	20	21
22	23	24	25	26	27	28
29	30	31				

30 - Memorial Day

05/20-05/23
WB HINGE 26

JUNE						
SUN	MON	TUE	WED	THU	FRI	SAT
			1	2	3	4
5	6	7	8	9	10	11
12	13	14	15	16	17	
19	20	21	22	23	24	25
26	27	28	29	30		

06/03-06/06
EB HINGE 2906/10-06/13
EB HINGE 26

JULY						
SUN	MON	TUE	WED	THU	FRI	SAT
					1	2
3	4	5	6	7	8	9
10	11	12	13	14	15	16
17	18	19	20	21	22	23
24	25	26	27	28	29	30
31	1					

4 - Independence Day

AUGUST						
SUN	MON	TUE	WED	THU	FRI	SAT
		2	3	4	5	6
7	8	9	10	11	12	13
14	15	16	17	18	19	20
21	22	23	24	25	26	
28	29	30	31			

08/05-08/08
EB HINGE 22 & 2408/19-08/22
WB HINGE 22 & 24

SEPTEMBER						
SUN	MON	TUE	WED	THU	FRI	SAT
				1	2	3
4	5	6	7	8	9	10
11	12	13	14	15	16	17
18	19	20	21	22	23	24
25	26	27	28	29	30	

5 - Labor Day

OCTOBER						
SUN	MON	TUE	WED	THU	FRI	SAT
						1
2	3	4	5	6	7	8
9	10	11	12	13	14	15
16	17	18	19	20	21	22
23	24	25	26	27	28	29
30	31					

10/14-10/17
WB HINGE 1910/21-10/24
EB HINGE 19

NOVEMBER						
SUN	MON	TUE	WED	THU	FRI	SAT
		1	2	3	4	5
6	7	8	9	10	11	12
13	14	15	16	17	18	19
20	21	22	23	24	25	26
27	28	29	30			

6 - Daylight Saving Time Ends

11 - Veterans Day

24, 25 - Thanksgiving & day after

DECEMBER						
SUN	MON	TUE	WED	THU	FRI	SAT
				1	2	3
4	5	6	7	8	9	10
11	12	13	14	15	16	17
18	19	20	21	22	23	24
25	26	27	28	29	30	31

26 = Holiday Off for Christmas Day

CROSTOWN VIADUCT BRIDGE REPAIR PROJECT

FACT SHEET (Draft 3/16/2016)
EA 10-1C0904 (10-SJ-4-PM-R16.6/R17.4)

LOCATION MAP:

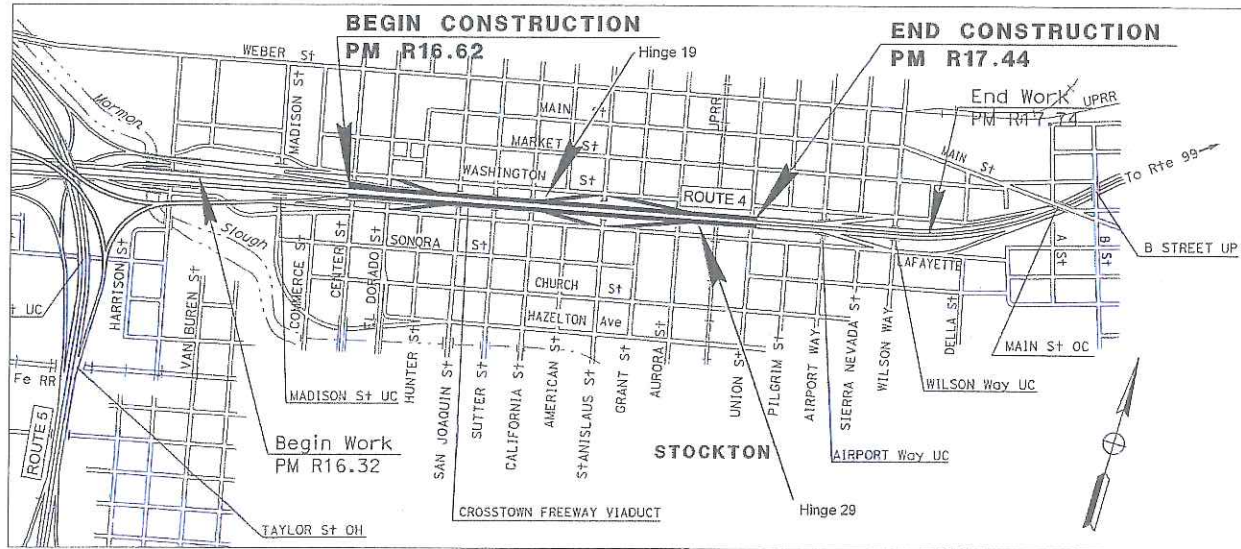

Project Description:

Reconstruct ten structure hinges (five in each direction), replace joint seals and elastomeric bearing pads, constructing longitudinal seismic restrainers at the Crosstown Freeway Viaduct (Bridge No. 29-0269) along State Route (SR) 4 in the City of Stockton, in San Joaquin County under Caltrans Contract No. 10-1C0904.

Project Contract Award Information:

- Contract Awarded: 10/9/2015
- Contract Working Days: 300
- Contractor: Golden State Bridge (GSB)
- Bid Amount: \$5,298,628.00

Value Engineering Change Proposal (VECP):

On 3/11/14, GSB submitted a draft VECP to D-10 Construction. The VECP proposes the following for the reconstruction of the ten structure hinges:

- Eight 55-hour full weekend closures of SR 4 lanes from 10pm Friday to 5am Monday (one direction at a time) to perform above-deck work. Closures will begin in April 2016 and will end in October 2016 (refer to calendar). There will be no 55-hour weekend closures in July and September as work will be done under the bridge.
- The eastbound and westbound directions of SR 4 will not be closed at the same time during a 55-hour weekend closure.
- Each 55-hour weekend closure will be used to reconstruct at least one hinge. Hinges 22 and 24 in the westbound direction will be completed in one 55-hour

weekend closure. The same hinges in the eastbound direction will also be reconstructed in one 55-hour weekend closure.

- GSB will use rapid strength concrete (RSC) to reconstruct concrete deck hinge.

Advantages of Using the VECP:

- Partial night closures significantly reduced from 140 partial lane night closures to only 15 partial lane night closures and eight 55-hour full weekend closures.
- Improved safety of workers and motorists since traffic will be detoured away from the work area.
- Working days will be reduced from 300 days to 250 days.
- Temporary decking (steel plates and tapers) will not be used – which avoids the anticipated bumpy rides and expected traffic noise.
- Cost Savings: Construction capital cost savings of about \$570,000; COZEEL cost (state expense) reduction estimated at \$400,000; and an estimated construction support cost savings of \$65,000.
- Caltrans D10 Maintenance will take advantage of the full lane weekend closures to perform necessary structure inspections, sweeping, drainage inlet cleaning, guardrail work, graffiti removal, etc.
- Significant reduction of partial lane night closures and early completion of this project will reduce impacts to six adjacent ongoing contracts along Interstate (I) 5 (widening and rehab) and along SR 4 (deck treatment and automated warning system installation).

Disadvantages of Using the VECP:

- Motorists will have to use detour routes (city/county roads) during closures which will add more travel distance and time during the eight 55-hr full weekend closures.

Action Items:

- Caltrans District 10 - Stockton (D10) will contact with SJCOG, City of Stockton and SJ County for input / feedback.
- D10 Public Information Office has developed and is ready to implement a comprehensive Communication/Public Outreach Plan for motorists, media and stakeholders.
- D10 Construction will coordinate and facilitate closures with adjacent construction contracts along I-5, SR 4 and SR 99.
- D10 Traffic has produced the draft detour plans.

Note: All above actions items are in progress in anticipation of the VECP approval.

D10 Contact Information:

Leo Martinez, Project Manager-D10

Phone: (209) 948-7854

E-mail: leo.martinez@dot.ca.gov



Dist

COUNTY

ROUTE

POST MILES
TOTAL PROJECT

SHEET
No.

TOTAL
SHEETS

10

SJ

4

R16.6/R17.4

4A

1

REGISTERED CIVIL ENGINEER

DATE

PLANS APPROVAL DATE

THE STATE OF CALIFORNIA OR ITS OFFICERS
OR AGENTS SHALL NOT BE RESPONSIBLE FOR
THE ACCURACY OR COMPLETENESS OF SCANNED
COPIES OF THIS PLAN SHEET.

PROFESSIONAL ENGINEER

No.

Exp.

CIVIL

STATE OF CALIFORNIA

CHANGEABLE MESSAGE SIGN					
HWY 4 W CLOSED USE OTHER EXITS	HWY 4 W CLOSED USE HWY 120 TO I-5	TO I-5 USE HWY 12 10 MILES AHEAD	TO I-5 USE HWY 12 7 MILES AHEAD	TO I-5 USE HWY 12 20 MILES AHEAD	TO I-5 USE HWY 120 12 MILES AHEAD
TUNE RADIO AM 1670	TUNE RADIO AM 1670	TUNE RADIO AM 1670	TUNE RADIO AM 1670	TUNE RADIO AM 1670	TUNE RADIO AM 1670
C3,C4	C1,C5,C6	C8	C9	C2	C7

PORTABLE CHANGEABLE MESSAGE SIGN		
HWY 4 WEST CLOSED	DOWNTOWN STOCKTON	TO I-5 USE HWY 12
USE HWY 120 TO I-5	USE NEXT EXIT	TUNE RADIO AM 1670
P1	P2,P4	P3,P5

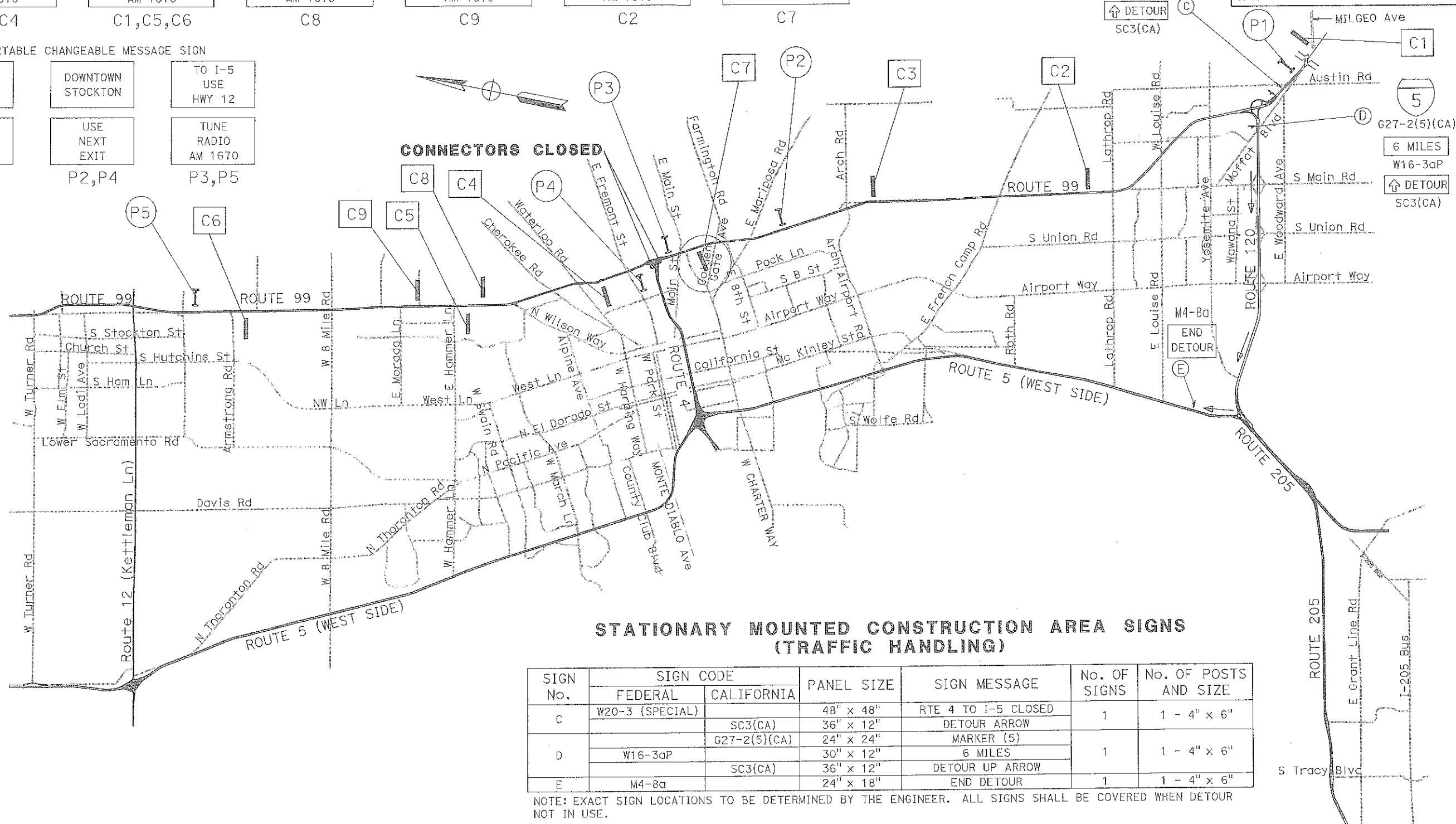

STATIONARY MOUNTED CONSTRUCTION AREA SIGNS
(TRAFFIC HANDLING)

SIGN No.	SIGN CODE		PANEL SIZE	SIGN MESSAGE	No. OF SIGNS	No. OF POSTS AND SIZE
	FEDERAL	CALIFORNIA				
C	W20-3 (SPECIAL)		48" x 48"	RTE 4 TO I-5 CLOSED	1	1 - 4" x 6"
		SC3(CA)	36" x 12"	DETOUR ARROW		
		G27-2(5)(CA)	24" x 24"	MARKER (5)		
D	W16-3aP		30" x 12"	6 MILES	1	1 - 4" x 6"
		SC3(CA)	36" x 12"	DETOUR UP ARROW		
E	M4-8a		24" x 18"	END DETOUR	1	1 - 4" x 6"

NOTE: EXACT SIGN LOCATIONS TO BE DETERMINED BY THE ENGINEER. ALL SIGNS SHALL BE COVERED WHEN DETOUR NOT IN USE.

PRELIMINARY
TRAFFIC HANDLING PLAN
(SOUTHBOUND/NORTHBOUND HWY 99 TO WESTBOUND ROUTE 4 CONNECTOR CLOSED)
NO SCALE
TH-4
APPROVED FOR TRAFFIC HANDLING WORK ONLY

NOTES (THIS SHEET ONLY):

1. LOCAL CROSS-STREETS MAY BE CLOSED.
2. REVISED STANDARD PLAN T-14 WILL BE USED FOR ALL RAMP AND CONNECTOR CLOSURES.
3. EXACT SIGN LOCATIONS WILL BE DETERMINED BY THE ENGINEER.
4. FOR (P3) & (P4) MESSAGE BOARDS, SEE SHEET TH-3.
5. ALL SIGNS SHALL BE COVERED WHEN DETOUR NOT IN USE.

STATIONARY MOUNTED CONSTRUCTION AREA SIGNS
(TRAFFIC HANDLING)

SIGN No.	SIGN CODE		PANEL SIZE	SIGN MESSAGE	No. OF SIGNS	No. OF POSTS AND SIZE
	FEDERAL	CALIFORNIA				
F		G28-2(CA)	24" x 25"	MARKER (4)	3	1 - 4" x 6"
		G28-2(CA)	24" x 25"	MARKER (99)		
		SC3(CA)	36" x 12"	DETOUR UP ARROW		
G	G77-4 (SPECIAL)		48" x 48"	MARKER (4) (LEFT ARROW) MARKER (99) (UP ARROW)	1	1 - 4" x 6"
H		G28-2(CA)	24" x 25"	MARKER (4)	1	1 - 4" x 6"
		M4-9(L)	30" x 24"	DETOUR (LEFT ARROW)		

DIST	COUNTY	ROUTE	POST MILES TOTAL PROJECT	SHEET No.	TOTAL SHEETS
10	SJ	4	R16.6/R17.4	5A	

REGISTERED CIVIL ENGINEER DATE

PLANS APPROVAL DATE

THE STATE OF CALIFORNIA OR ITS OFFICERS OR AGENTS SHALL NOT BE RESPONSIBLE FOR THE ACCURACY OR COMPLETENESS OF SCANNED COPIES OF THIS PLAN SHEET.

REGISTERED PROFESSIONAL ENGINEER
No. _____
Exp. _____
CIVIL
STATE OF CALIFORNIA

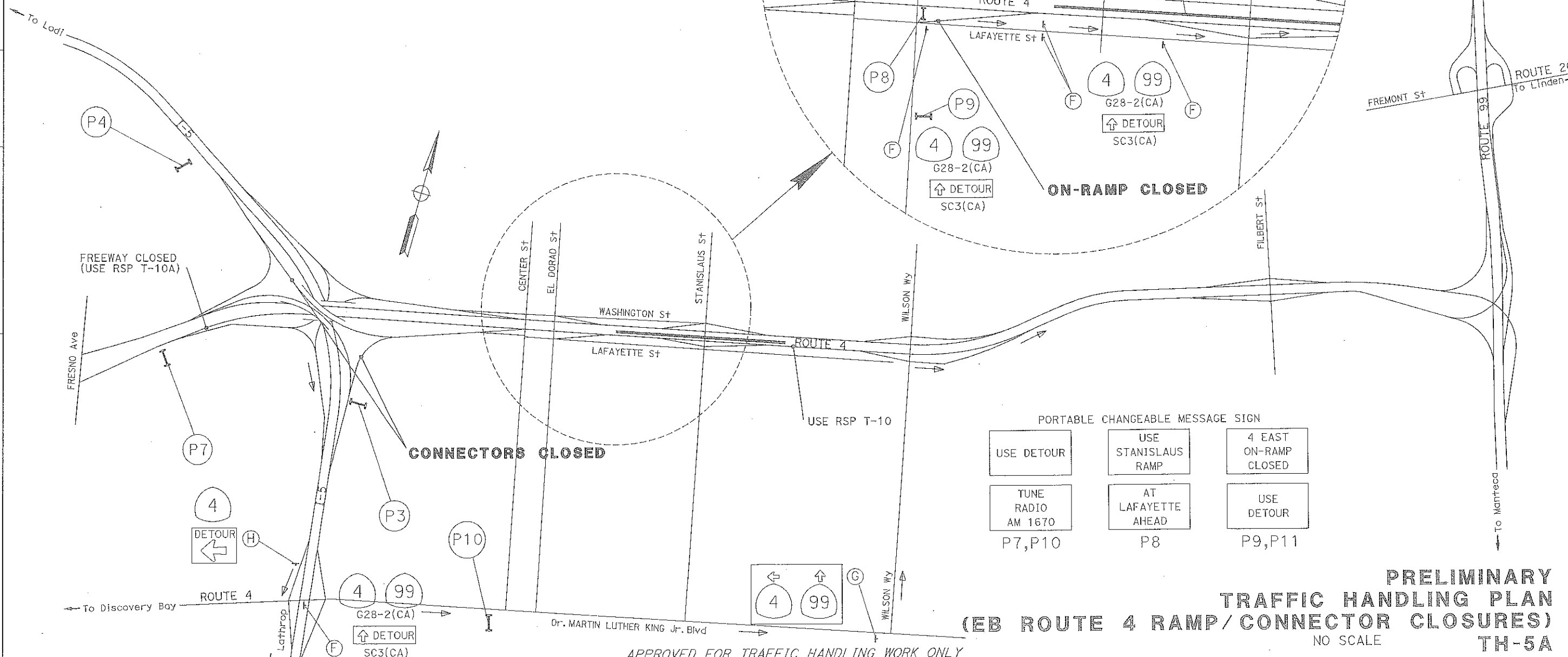

NOTES (THIS SHEET ONLY):

1. LOCAL CROSS-STREETS MAY BE CLOSED.
2. REVISED STANDARD PLAN T-14 WILL BE USED FOR ALL RAMP AND CONNECTOR CLOSURES.
3. EXACT SIGN LOCATIONS WILL DETERMINED BY THE ENGINEER.
4. FOR (P3) & (P4) MESSAGE BOARDS, SEE SHEET TH-3.
5. THIS SHEET TO BE USED ONLY WHEN WORKING ON LOCATION 29.
6. SIGN(S) TO REMAIN IN PLACE IF POSTED ON CITY'S SL POLE OR NEW INSTALLATION ON UNIT STRUTS.
7. ALL SIGNS SHALL BE COVERED WHEN DETOUR NOT IN USE.

STATIONARY MOUNTED CONSTRUCTION AREA SIGNS
(TRAFFIC HANDLING)

SIGN No.	SIGN CODE		PANEL SIZE	SIGN MESSAGE	No. OF SIGNS	No. OF POSTS AND SIZE
	FEDERAL	CALIFORNIA				
F		G28-2(CA)	24" x 25"	MARKER (4)	2	1 - 4" x 6"
		G28-2(CA)	24" x 25"	MARKER (99)		
		SC3(CA)	36" x 12"	DETOUR UP ARROW		
G	G77-4 (SPECIAL)		48" x 48"	MARKER (4) (LEFT ARROW)	1	1 - 4" x 6"
				MARKER (99) (UP ARROW)		
H		G28-2(CA)	24" x 25"	MARKER (4)	5	1 - 4" x 6"
		M4-9(L)	30" x 24"	DETOUR (LEFT ARROW)		
N		M4-9(R)	30" x 24"	DETOUR (RIGHT ARROW)	1	1 - 4" x 6"
P		M4-9(L)	30" x 24"	DETOUR (LEFT ARROW)	1	1 - 4" x 6"
Q	G77-4 (SPECIAL)		48" x 48"	MARKER (4) (RIGHT ARROW)	1	1 - 4" x 6"
				MARKER (99) (RIGHT ARROW)		
R	G77-4 (SPECIAL)		48" x 48"	MARKER (4) (LEFT ARROW)	1	1 - 4" x 6"
				MARKER (99) (LEFT ARROW)		
S	G82 (SPECIAL)		30" x 24"	DOWNTOWN (LEFT)	1	1 - 4" x 6"

Dist	COUNTY	ROUTE	POST MILES TOTAL PROJECT	SHEET No.	TOTAL SHEETS
10	SJ	4	R16.6/R17.4	5B	

REGISTERED CIVIL ENGINEER DATE

PLANS APPROVAL DATE

THE STATE OF CALIFORNIA OR ITS OFFICERS OR AGENTS SHALL NOT BE RESPONSIBLE FOR THE ACCURACY OR COMPLETENESS OF SCANNED COPIES OF THIS PLAN SHEET.

REGISTERED PROFESSIONAL ENGINEER
No.
Exp.
CIVIL
STATE OF CALIFORNIA

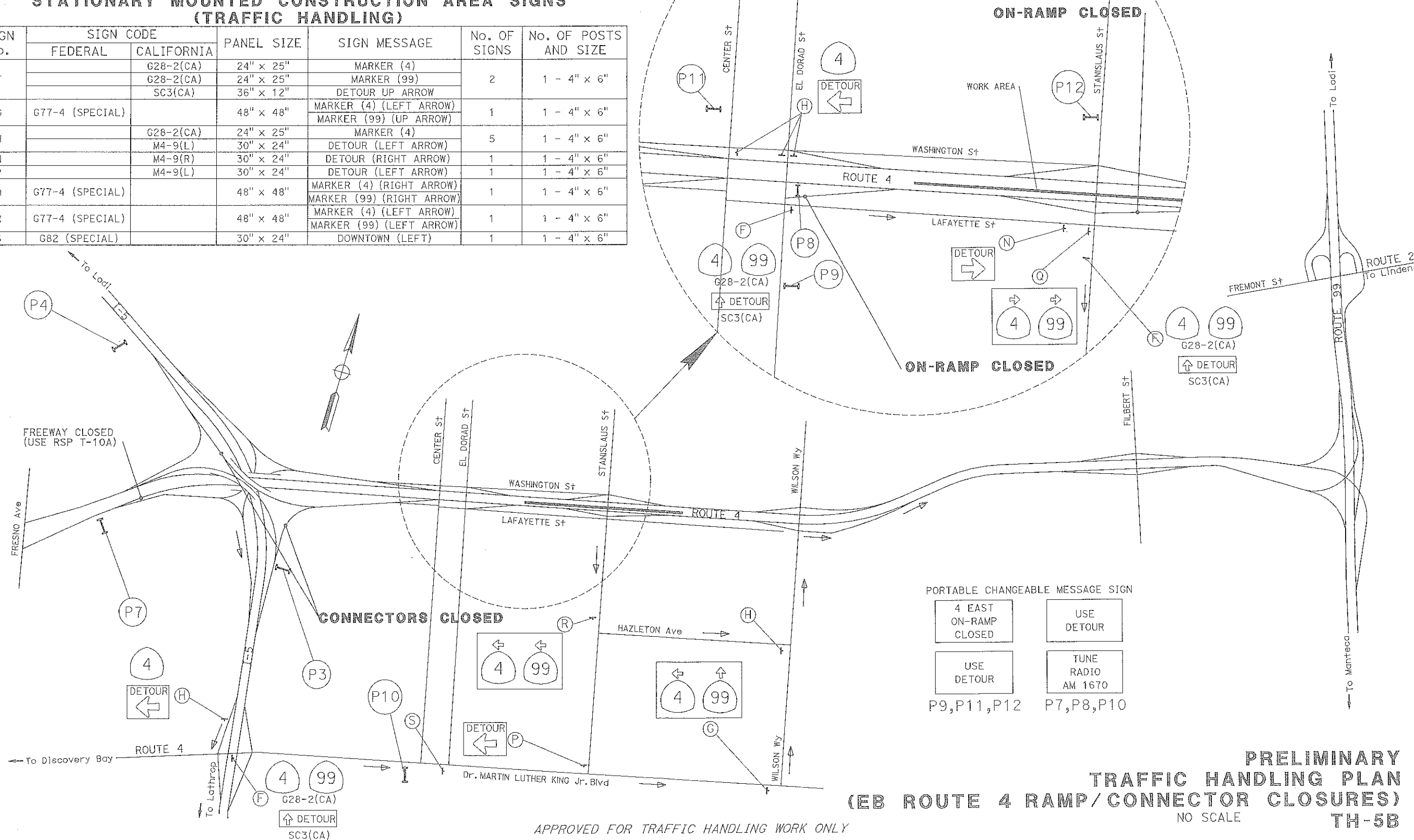

Dist	COUNTY	ROUTE	POST MILES TOTAL PROJECT	SHEET No.	TOTAL SHEET
10	SJ	4	R16.6/R17.4	6A	

REGISTERED CIVIL ENGINEER DATE

PLANS APPROVAL DATE

THE STATE OF CALIFORNIA OR ITS OFFICERS
OR AGENTS SHALL NOT BE RESPONSIBLE FOR
THE ACCURACY OR COMPLETENESS OF SCANNED
COPIES OF THIS PLAN SHEET.

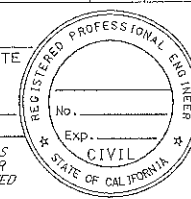

NOTES (THIS SHEET ONLY):

1. LOCAL CROSS-STREETS MAY BE CLOSED.
2. REVISED STANDARD PLAN T-14 WILL BE USED FOR ALL RAMP AND CONNECTOR CLOSURES.
3. EXACT SIGN LOCATIONS WILL DETERMINED BY THE ENGINEER.
4. FOR (P3) & (P4) MESSAGES BOARDS, SEE SHEET TH-4.
5. AS NEEDED, PROVIDE FLAGGERS AND LIGHT PLANTS AT STANISLAUS STREET ON/OFF-RAMPS.
6. SIGN (N) TO REMAIN IN PLACE IF POSTED ON CITY'S SL POLE OR NEW INSTALLATION ON UNIT STRUTS.
7. ALL SIGNS SHALL BE COVERED WHEN DETOUR NOT IN USE.

PORTABLE CHANGEABLE MESSAGE SIGN

USE
DETOUR

TUNE
RADIO
AM 1670

P6, P7

ON-RAMP OPEN

USE RSP T-10

WORK AREA

FREEWAY CLOSED
(USE RSP T-10A)

ROUTE 4

CONNECTORS CLOSED

G28-2(CA) G27-2(5)(CA)

M4-9(R

G28-2(CA) G27-2(5)(CA)

M4-9(R)

STATIONARY MOUNTED CONSTRUCTION AREA SIGNS (TRAFFIC HANDLING)

SIGN No.	SIGN CODE		PANEL SIZE	SIGN MESSAGE	No. OF SIGNS	No. OF POSTS AND SIZE
	FEDERAL	CALIFORNIA				
J		G28-2(CA)	24" x 25"	MARKER (4)	1	1 - 4" x 6"
		G27-2(5)(CA)	24" x 24"	MARKER (5)		
		M4-9(R)	30" x 24"	DETOUR (RIGHT ARROW)		
K		G28-2(CA)	24" x 25"	MARKER (4)	1	1 - 4" x 6"
		G27-2(5)(CA)	24" x 24"	MARKER (5)		
		M4-9(L)	30" x 24"	DETOUR (LEFT ARROW)		
L		SC3(CA)	36" x 12"	DETOUR ARROW	2	1 - 4" x 6"
M	G77-4 (SPECIAL)		48" x 48"	MARKER (4) (UP ARROW)	1	1 - 4" x 6"
				MARKER (99) (UP ARROW)		
N	G82 (SPECIAL)		30" x 24"	DOWNTOWN (RIGHT)	1	1 - 4" x 6"

APPROVED FOR TRAFFIC HANDLING WORK ONLY

PRELIMINARY
TRAFFIC HANDLING PLAN
(WB ROUTE 4 CONNECTOR CLOSURES)
NO SCALE TH-6A

BORDER LAST REVISED 7/2/2010

```

USERNAME => s132864
DGN FILE => a1c090md006A.dgn

```

RELATIVE BORDER SCALE
IS IN INCHES

UNIT 2593

PROJECT NUMBER & PHASE

10140001331

DATE PLOTTED => 07-APR-2016	LAST REVISION
TIME PLOTTED => 16:03	04-01-16

